



THE *Fairmont*
PALM RESIDENCE





THE FAIRMONT PALM RESIDENCE - TOWNHOUSES

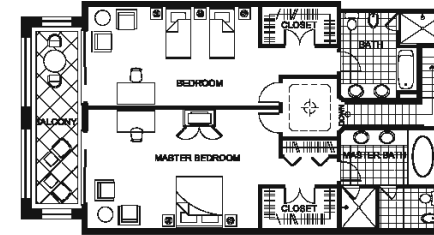

Level 3

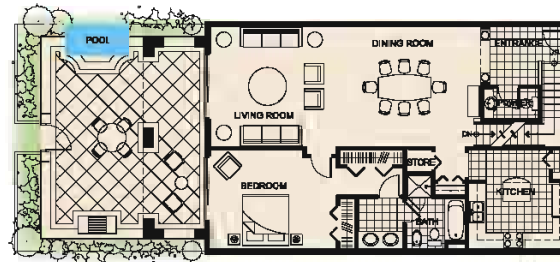

Level 2

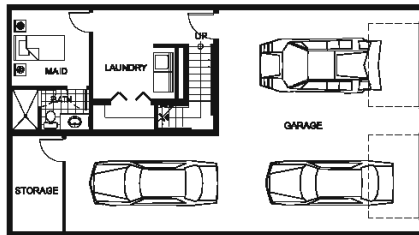

Level 1

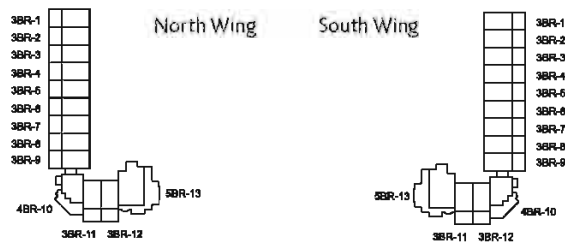

Townhouses - 3 Bedroom

Approximate Areas:

Level 1 - Garage	152 m ²	1,637 ft ²
Level 2 - Living	132 m ²	1,424 ft ²
Level 2 - Terrace	52 m ²	565 ft ²
Level 3 - Living (including balcony)	152 m ²	1,637 ft ²
Total	488 m²	5,257 ft²































































